

CYLINDRICAL LEVER LOCKSETS



CYLINDRICAL LEVER LOCKSETS

SmartLoc Tundra & Sierra Cylindrical Lever Locksets Series

Grade 1 Locksets

SmartLoc Ranger & Colt Cylindrical Lever Locksets Series

Grade 2 Locksets

SLT1000 Tundra Series



SLR2000 Ranger Series



SLS1000 Sierra Series



SLC2000 Colt Series



SmartLoc Technology

10125 S. 52nd Street

Franklin, WI 53132

Tel: (888) 651-LOCK, Fax: 414-858-9340

sales@smartlocworld.com

www.SmartLocWorld.com

SLT1000 Series

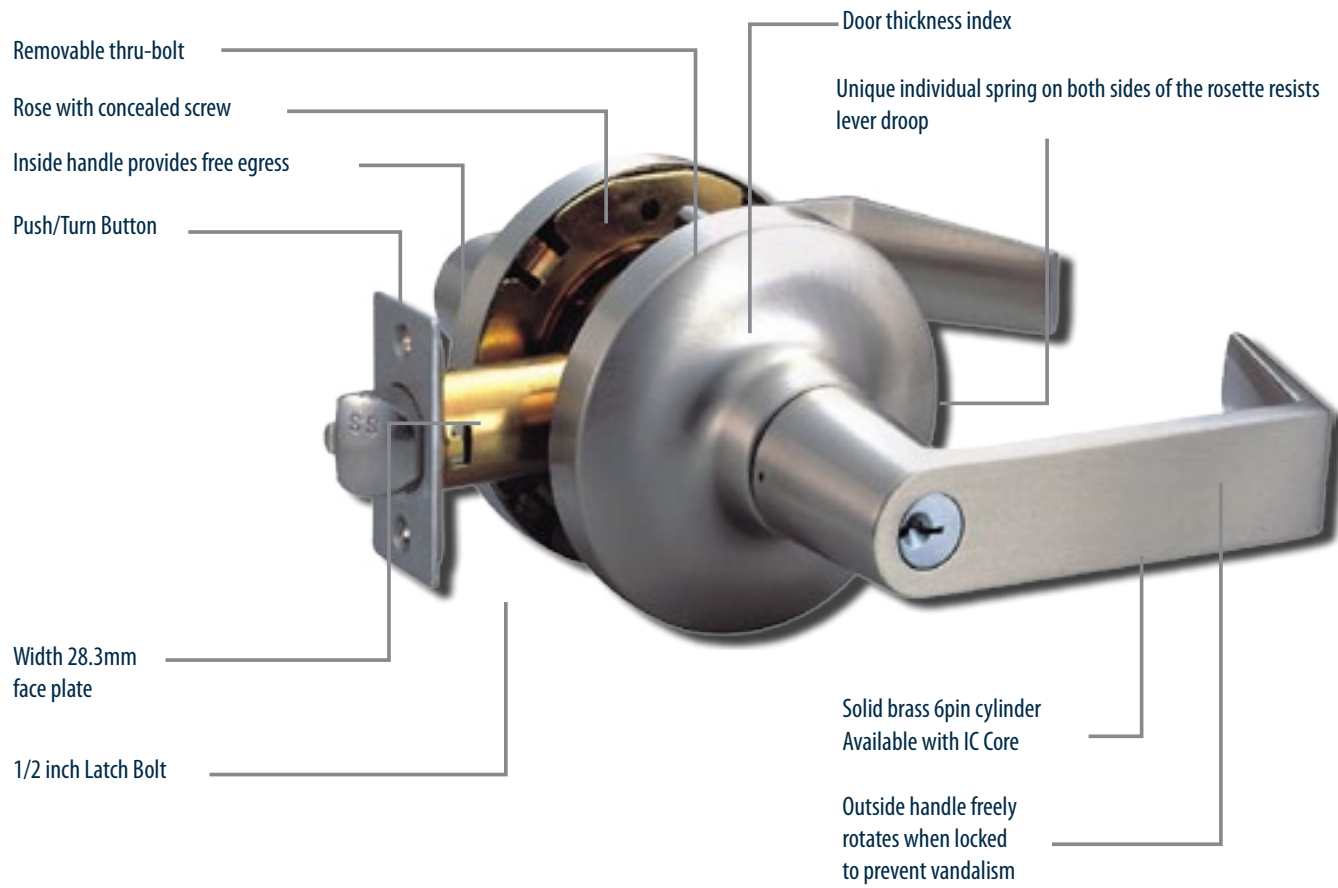

IC Core



Small format Interchangeable Core

- Ideal and easy way for non-professional users to change the cylinder
- Compatible with:
 - 6/7 pin cylinder
 - Best keyway
 - Lockbody of all the famous brands including:
Schlage, Arrow, Best, Falcon & KSP
 - KD, KA, MK, GMK, GGMK, MCK keying system

SLT1000 Series

Certifications

- ANSI / BHMA A156.2-2003 Grade 1
- UL10C - Three hour fire rated

Handing

All locksets are non-handed (install right or left)

Leverset Features

Backset

- Available with 2-3/4" (70 mm) standard, 2-3/8" (60 mm), 3-1/3" (85 mm), or 5" (127 mm)

Cylinders

- Brass 6 pin standard Schlage keyway (other keyways available upon request)

Design Features

- Durable and secure lock body designed for Heavy Duty use.

Durable Torsion Spring: Levers are supported by a durable spring on both sides of the rosette to resist handle sag over time.

LEVER DIMENSION

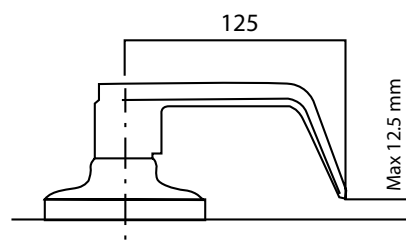

Meet CA Title 19 standard

Adjustable Mounting Plate

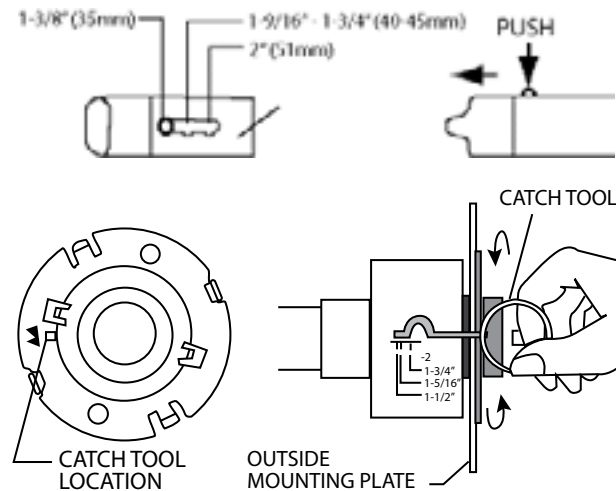

The mounting plate can be adjusted to meet the door thickness from 1-3/8" to 2" (35 – 51 mm).

An indicator on the lock body is used with a catch tool to properly adjust the lock to the door thickness.

Ordering

Ordering the Grade 1 locks with Tundra handle style (T) requires specification of the model number and finish

The Model numbers are as follows:

SLT1000	Entry Lock
SLT1000IC	Entry Lock with IC Core
SLT1003	Classroom Lock
SLT1005	Storeroom Lock
SLT1020	Privacy Lock
SLT1030	Passage Lock

Finishes offered are:

26D	626	Satin Chrome
US3	605	Bright Brass
ORB	613	Oil Rubbed Bronze

For example, if you want to order a storeroom lock with a Bright Brass finish you would order **SLT1005-US3**

SmartLoc Sierra Cylindrical Lever Locksets

SmartLoc Sierra Series

An Grade 1 cylindrical key-in-lever lockset designed to exceed the requirements of ANSI A 156.2 Series 4000 Grade I furnished standard with a 2 3/4" backset with other backsets available on request. Meets ADA requirements

SLS1000 26D

ANSI Grade I,
UL Listed Type ALS Entrance,
L Lever, ASA Strike,
Polished Brass Finish
Stainless Steel Latchbolt,
Solid Brass Schlage
6 pin keyway Cylinder
Meets Fire Code
(California State Reference Code)
UL and cUL Listed
Seven Year Mechanical Warranty



Features

- Chassis is standard and I/C lever variations available, allows for versatile applications.
- Quality cast and machined stainless steel hubs mounted with heavy duty return springs tested over one million cycles without any visible lever sag.
- Heavier rose liners material provides more attack resistance.
- Heat treated heavy gauge cold rolled steel spindles withstand 1,000 inch pound of torque applied to the locked lever without gaining access.
- Threaded outside rose assembly adjustable for door thickness without removing keyed lever

SmartLoc Sierra Cylindrical Lever Locksets

SmartLoc Sierra Series Specifications

Applications	For Schools, Hospitals, Factories, Offices, Hotel and Other Public Buildings
For Doors	1 3/8" to 2" (40mm to 52mm)
Backset	2 3/4"(70mm) Standard, 2 3/8"(60mm) Optional
Front	Brass, Bronze; 2 1/4" X 1 1/8" Adjustable for Flat or Beveled Doors 1/8 in 2"
Strike	Brass, Bronze; ASA Strike Standard (Other Strikes Available)
Roses	Brass or Bronze
Hand	Universal, Non-Handed
Latchbolt	Stainless Steel, 17/32" (13.5mm) Throw
Keys	Two, Brass
Cylinder	Brass, Schlage 6 pin keyway standard Weiser, Arrow, Lockwood, Kwikset Optional
Master Key	Can be Masterkeyed or Grand Masterkeyed
I/C Core	6 or 7 pins, Compatible with Best® and Falcon®
Finish	3, 4, 10, 10B, 26, 26D
Split Finishes	Outside Finish Specified First. Front and Strike Finished to match inside Trim unless otherwise specified
UL & cUL	Listed for use on Fire Doors (3 Hour Rated)

Door Preparation

If weather-stripping, acoustical materials or silencers are used on the door or frame, care must be taken in the installation so that it will not interfere with the ease in which the latchbolt enters the strike.

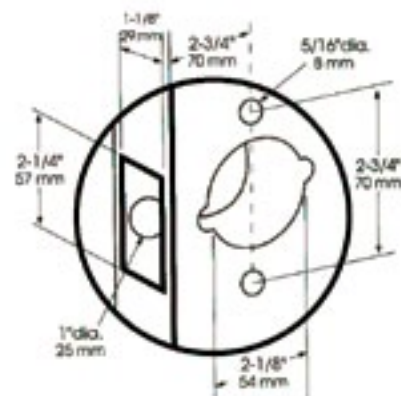

Type SmartLoc Sierra Standard Cutout

SmartLoc Sierra Cylindrical Lever Locksets

SmartLoc Sierra Series Lever & Rose Designs

'L' Lever with 'Flat' Rose

Complies with codes requiring
Lever to return to within 1/2 of door face.

Lever: Solid Zinc Cast
Rose: Brass or Bronze

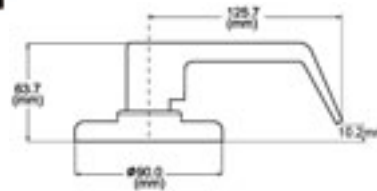

'R' Lever with 'Flat' Rose

Complies with codes requiring
Lever to return to within 1/2" of door face.

Lever: Solid Zinc Cast
Rose: Brass or Bronze

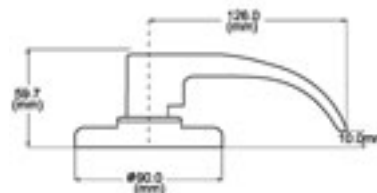

SmartLoc Sierra Cylindrical Lever Locksets

SmartLoc Sierra Series Latch & Strike Parts

SmartLoc Sierra Series are Adjustable for Flat or Beveled Edge Doors. Latches and Strikes are furnished in Brass, Bronze or Chrome finishes to be compatible with Lock Trim. When Ordering, Specify Quantity, Part Number, and Finish. All Latches have 17/32" (13.5mm) Throw.

Latches

To order latchbolt separately, specify Part No. x Finish

Backset	Descriptions (Square Corner standard)	Part Number	
		Deadlatch	Springlatch
2 3/8" (60 mm)	1 1/8"(29mm) X 2 1/4"(57mm)	ENT-WD/60	PRI-WD/60
2 3/4" (70 mm)	1 1/8"(29mm) X 2 1/4"(57mm)	ENT-WD/70	PRI-WD/70

Square Corner Latches

Springlatch

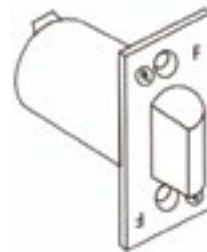

Deadlatch

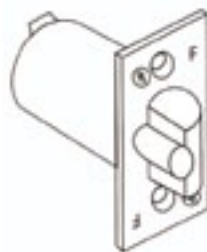

SmartLoc Sierra Cylindrical Lever Locksets

SmartLoc Sierra Series Latch & Strike Parts

ASA Strike (Standard)

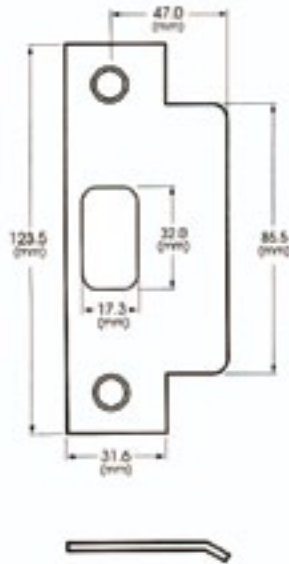

To order strike separately, Specify No. ASA Strike X Finish Required.
Other strikes Available.

Door Bevel

The edge of a door is beveled on the side opposite the hinges to provide clearance for the swing of a snug fit. The standard bevel is 1/8" for each 2" of door thickness.

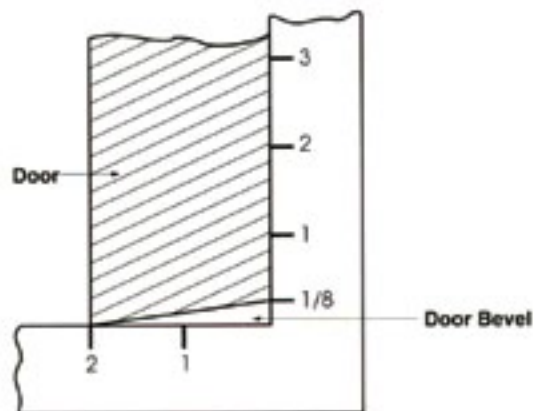

Typical Door Bevel

SmartLoc Sierra Cylindrical Lever Locksets

SmartLoc Sierra Locksets Exploded View Drawing

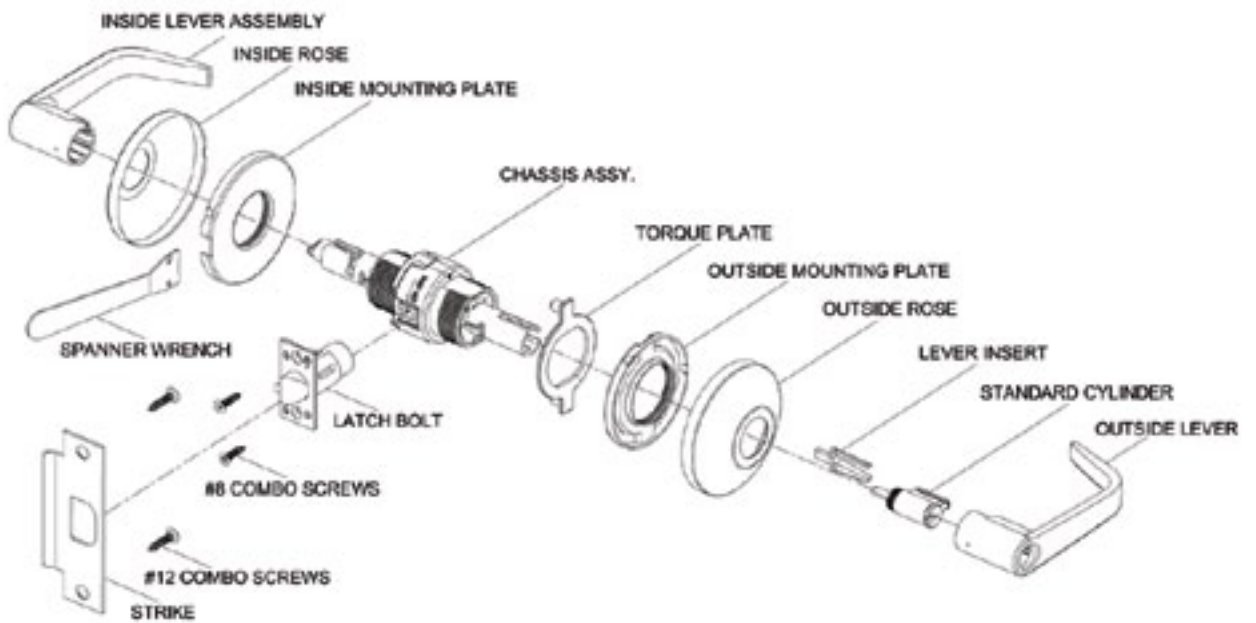



Standard Features

Door Thickness

- Supports doors 1-3/8" (35 mm) to 1-3/4" (45 mm) thick

Keyway

- Schlage C, standard

Keying

- 2 nickel-plated brass keys per lock
- Keyed Different

Backset

- 2-3/4" (70mm)

Optional Features

Door Thickness

- 2" (51mm) Door support

Keyway

- SE, KW, WR Keyway

Keying

- Keyed Alike
- Master Keyed
- Grand Master Keyed
- Construction Key System

Backset

- 2-3/8" (65mm)
- 3-3/4" (95mm)
- 5" (127mm)

Certifications

- ANSI / BHMA A156.2-2003 Grade 2
- UL10C - Three hour fire rated latch

Construction

Solid Zinc cylinder housing with Brass 6-pin tumbler cylinder

Latchbolt

Stainless Steel 1/2" (12.5mm) throw

Strike

1-1/8" (28.5 mm) x 2-3/4" (70 mm) x 5/64" (2 mm)
T-strike Standard.

Full-Lip Strike or ANSI Strike - Optional

Ordering

Ordering the Grade 2 locks with Ranger handle style (R) requires specification of the model number and finish

The Model numbers are as follows:

SLR2000	Entry Lock
SLR2000IC	Entry Lock with IC Core
SLR2003	Classroom Lock
SLR2005	Storeroom Lock
SLR2020	Privacy Lock
SLR2030	Passage Lock

Finishes offered are:

US26D	626	Satin Chrome
US3	605	Bright Brass
ORB	613	Oil Rubbed Bronze

For example, if you want to order a Privacy lock with Satin Chrome finish you would order **SLR2020-26D**

Handle Styles

Broadway Lever



Broadway Lever with IC Core



Dimensions

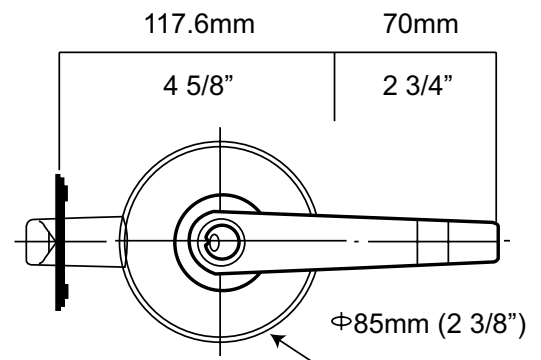

SmartLoc Colt Cylindrical Lever Locksets

SmartLoc Colt Grade 2 Series

Meets ADA requirements.

A Standard Heavy Duty key-in-lever lockset designed to exceed the requirements of ANSI A I52. 2 Series 4000 and Grade II.



SLC1000 26D Flat ASA

ANSI Grade II, UL Listed

Type SmartLoc Colt Entrance, L Lever, ASA Strike, Stain Chrome Plated Finish

Solid Brass Latchbolt, Solid Brass Schlage 6 Pin Keyway Cylinder

Cylinder Meets Fire Code (California State Reference Code)

UL and cUL Listed

Five Year Mechanical Warranty

Heavy Duty Lever Spring return Rose Assembly

Bidirectional Lever operation, Non-Handed

Convertible Posts

Available with Free Wheeling Mechanism

Door Preparation

If weather-stripping, acoustical materials or silencers are used on the door or frame, care must be taken in the installation so that it will not interfere with the ease in which the Latchbolt enters the strike.

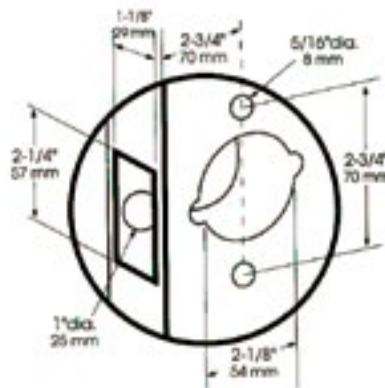

Type SmartLoc Colt Standard Cutout

W-Standard Front 1 \"(25mm) x 2 1/4\"(57mm)

Wide Front : 1 1/8\"(29mm) X 2 1/4\" (57mm)

SmartLoc Colt Cylindrical Lever Locksets

SmartLoc Colt Grade 2 Series Specifications

Applications	For Schools, Hospitals, Factories, Offices, Hotel and Other Public Buildings
For Doors	1 3/8" to 1 3/4" (35mm to 45mm)
Backset	2 3/8"(60mm) or 2 3/4"(70mm) Standard 3 1/2"(90mm), 3 3/4"(95mm), 5"(127mm) Optional
Front	Brass, Bronze; 2 1/4" X 1" Standard. 2 1/4" X 1 1/8" Optional Adjustable for Flat or Beveled Doors 1/8" in 2"
Strike	Brass, Bronze; ASA Strike Standard Full-lip & K203-G2(Anti-rattle) Strike Available
Roses	Brass or Bronze
Hand	Universal, Non-Handed
Latchbolt	Brass, 1/2" throw Standard. Stainless Steel, 1/2" throw Optional
Keys	Two, Brass
Cylinder	Brass, Schlage 6 pin Keyway Standard Weiser, Arrow, Lockwood, Kwikset Optional
Master Key	Can be Masterkeyed or Grand Masterkeyed
I/C Core	6 or 7 pins, Compatible with Best® and Falcon®
Wheeling	Free Wheeling Mechanism available on all Keyed Locks
Finish	3, 4, 10, 10B, 26, 26D
Split Finishes	Outside finish specified first. Front and Strike finished to match inside trim unless otherwise specified
UL & cUL	Listed for use on Fire Doors (3 Hour Rated)



SmartLoc Colt Grade 2 Cylindrical Lever Locksets

SmartLoc Colt Grade 2 Series Lever & Rose Designs

'L' Lever with 'Flat' Rose

Complies with codes requiring
Lever to return to within 1/2 of door face.

Lever: Zinc Cast

Rose: Brass or Bronze

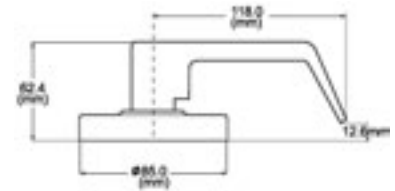
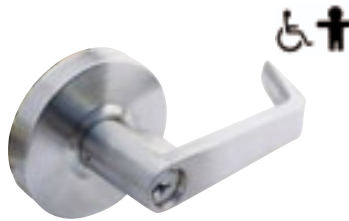

'R' Lever with 'Round' Rose

Complies with codes requiring
Lever to return to within 1/2" of door face.

Lever: Zinc Cast

Rose: Brass or Bronze

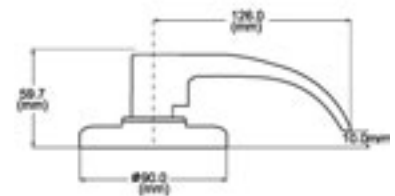

Rose Designs

Round Rose



Flat Rose



SmartLoc Colt Grade 2 Cylindrical Lever Locksets

SmartLoc Colt Series Latch Parts

SmartLoc Colt Series are adjustable for flat or beveled edge doors. Latches and strikes are furnished in brass, bronze or chrome finishes to be compatible with lock trim. When ordering, specify quantity, part number, and finish. All latches have 1/2" throw.

Latches

To order Latchbolt separately, Specify Part # X Finish required

Backset	Descriptions (Square Corner standard)	Part Number	
		Deadlatch	Springlatch
2 3/8" (60mm)	1 1/8" (29mm) X 2 1/4" (57mm)	ENT-WD/60	PRI-WD/60
	1" (25mm) X 2 1/4" (57mm)	ENT-STD/60	PRI-STD/60
	1" (25mm) Drive-In	ENT-DR/60	PRI-DR/60
2 3/4" (70mm)	1 1/8" (29mm) X 2 1/4" (57mm)*	ENT-WD/70	PRI-WD/70
	1" (25mm) X 2 1/4" (57mm)	ENT-STD/70	PRI-STD/70
	1" (25mm) Drive-In	ENT-DR/70	PRI-DR/70
3 1/2" (90mm)	1 1/8" (29mm) X 2 1/4" (57mm)	ENT-WD/90	PRI-WD/90
	1" (25mm) X 2 1/4" (57mm)	ENT-STD/90	PRI-STD/90
3 3/4" (95mm)	1 1/8" (29mm) X 2 1/4" (57mm)	ENT-WD/95	PRI-WD/95
	1" (25mm) X 2 1/4" (57mm)	ENT-STD/95	PRI-STD/95
5" (127mm)	1 1/8" (29mm) X 2 1/4" (57mm)	ENT-WD/127	PRI-WD/127
	1" (25mm) X 2 1/4" (57mm)	ENT-STD/127	PRI-STD/127
**)-Standard & Round Corner Latches Available on Request			

Square Corner Latches

Round Corner Latches

Drive-In Latches

Springlatch

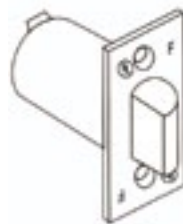

Springlatch

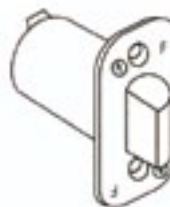

Springlatch



Deadlatch

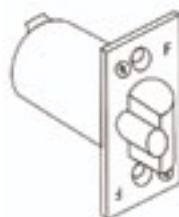

Deadlatch

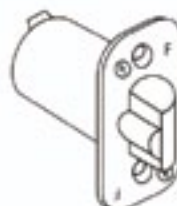

Deadlatch



SmartLoc Colt Grade 2 Cylindrical Lever Locksets

SmartLoc Colt Series Latch Parts

Latch Front Adapter

Used to convert 1" wide square front faceplates for 1 1/8" wide door preparations. Furnished in white plastic.



Long Backsets

Backsets 5" extension links.

Long backsets are normally furnished with 1" faceplates and 7/8" housings.

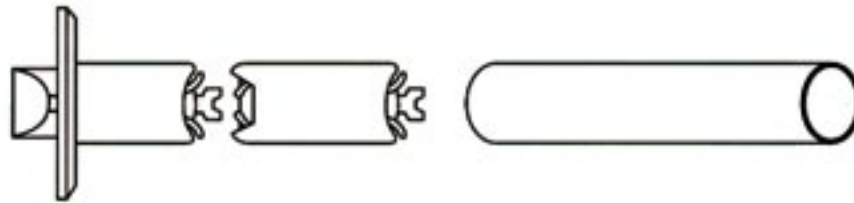

5" Extension Link

Latch Sleeve

Included with 2 3/4" backset latches to fill 1" edge bores (Optional).

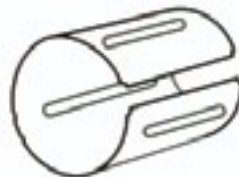

Door Bevel

The edge of a door is beveled on the side opposite the hinges to provide clearance for the swing of a snug fit.

The standard bevel is 1/8" for each 2" of door thickness.

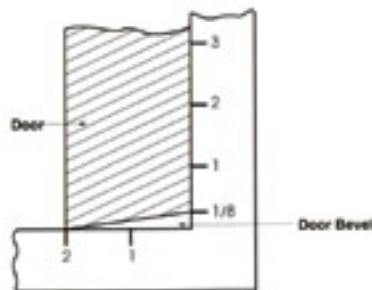

Typical Door Bevel

SmartLoc Colt Grade 2 Cylindrical Lever Locksets

SmartLoc Colt Series Latch Parts

K203-G2 Strike

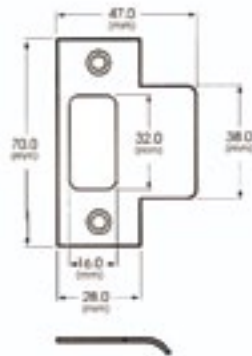

K203-G2 (Anti-rattle) Strike



Conforms to ANSI standard A 115.3 furnished standard with curved lip 1 1/4" from center of strike to end of lip.

To order strike separately, specify K203-G2 X Finish.

U204 Full-lip strike

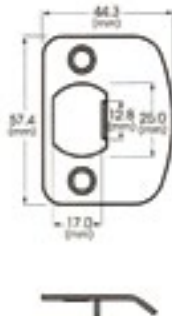

D203 Full-lip strike

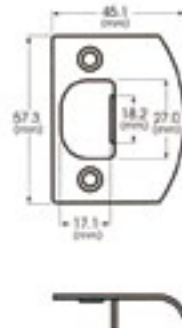

U203 Full-lip strike

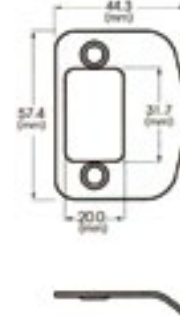

ASA Standard Strike*



Available for SmartLoc Colt Locksets

SmartLoc Colt Grade 2 Cylindrical Lever Locksets

SmartLoc Colt Locksets Exploded View Drawing

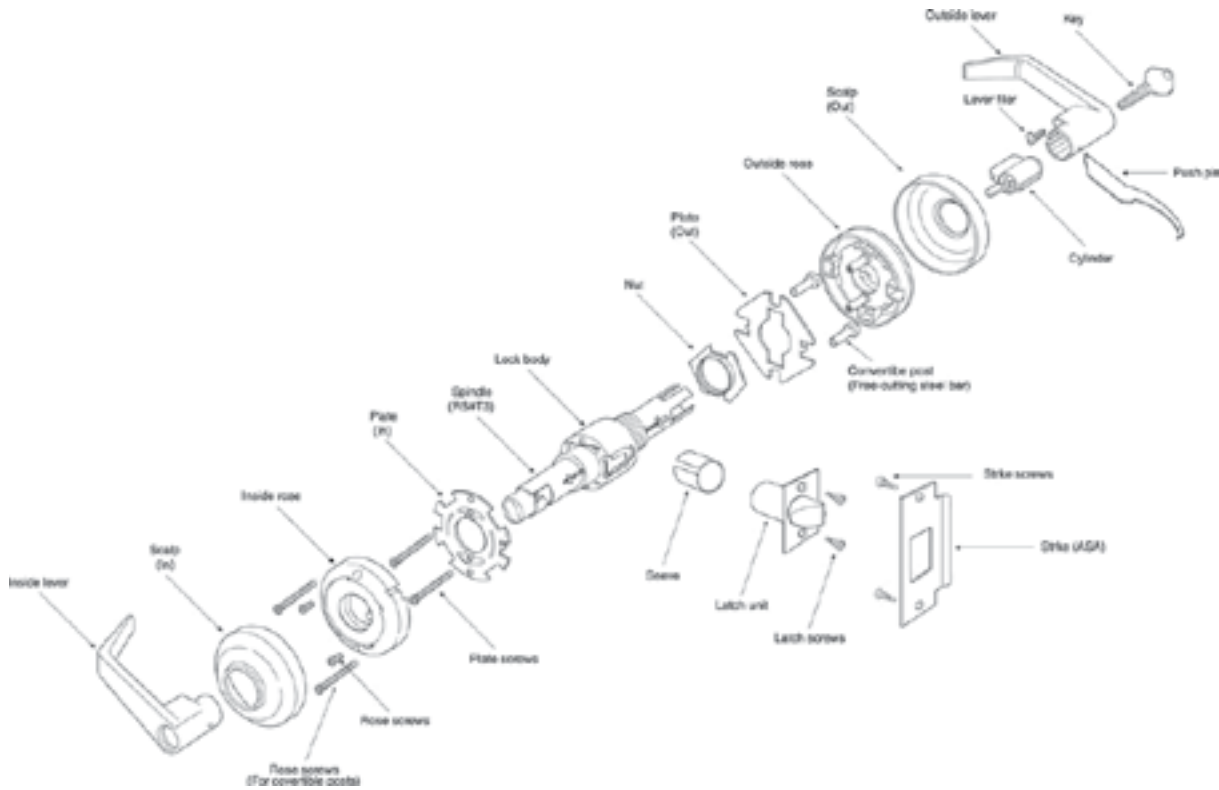

SmartLoc Order Information

How To Order

SL S 1000 S 26D

Finishes	
Code	Description
3	Polished Brass
4	Satin Brass
10	Satin Bronze
10B	Oxidized Bronze, Oil Rubbed
26	Polished Chrome Plated
26D	Satin Chrome Plated
32	Polished Stainless Steel
32D	Stain Stainless Steel

Lever Design	
	Straight
	Curved

Series	
T = Tundra:	Grade I
S = Sierra:	Grade I
C = Colt:	Grade II
R = Ranger:	Grade II
D = Deadbolt:	Grade II
M = Mortise:	Grade I
E = Exit:	Grade I
H = Hinge:	Grade II
F = Frontier:	Grade II

Function	
1030:	Passage
1020:	Privacy
1000:	Entrance
1003:	Classroom
1005:	Storeroom
1080/1090:	Hotel/Motel
1090:	Communicating
1095:	Dummy/Double
1096:	Dummy/Single

Please note:
 1000 Series = Grade 1
 2000 Series = Grade 2



Cylindrical Lever Locksets

Finishes

US Code	Description
3	Polished Brass
4	Satin Brass
10	Satin Bronze
10B	Oxidized Bronze, Oil Rubbed
26	Polished Chrome Plated
26D	Satin Chrome Plated
32	Polished Stainless Steel
32D	Stain Stainless Steel

*Zinc Levers are plated to match BHMA finish.
Custom Colors Available*

Door Handing

Hand information is necessary to ensure proper finish of latchbolt and strike for locks ordered that are to be installed on reverse bevel doors. Follow the diagram to correctly determine the hand of the door.

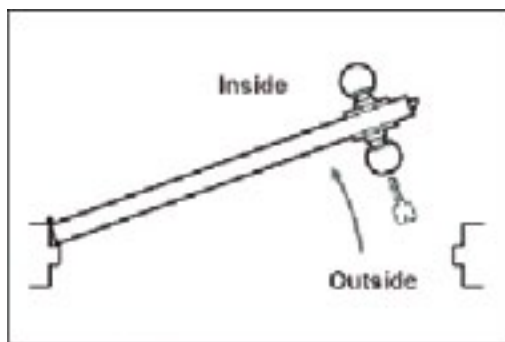

Left Hand / LH

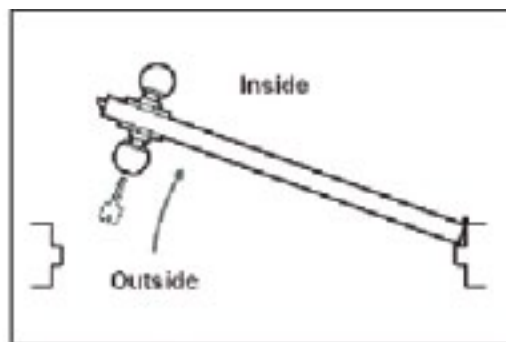

Right Hand / RH

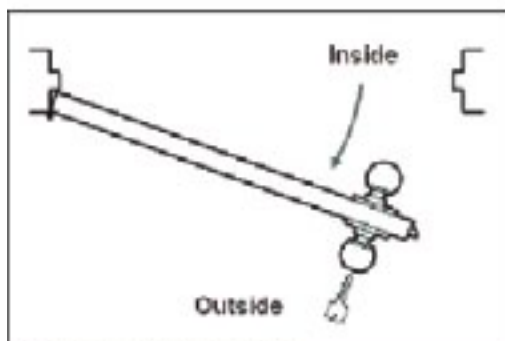

Left Hand Reverse / LHR

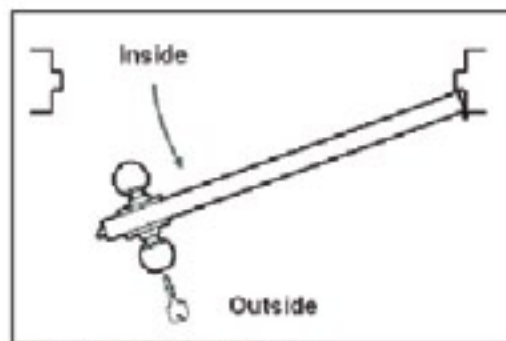



Right Hand Reverse / RHR

Note

A series of horizontal dotted lines for taking notes, spanning the width of the page below the "Note" header.



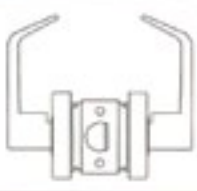
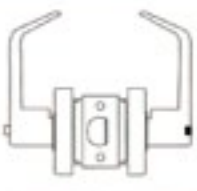
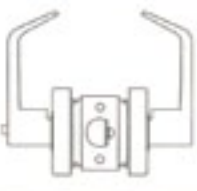
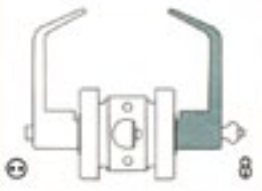
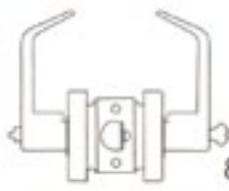
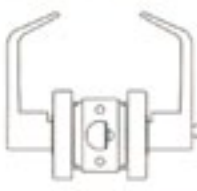



Cylindrical Lever Locksets

Function

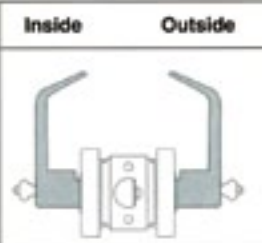
Inside	Outside	Type	ANSI	Function Description
		Passage	HF 75	<ul style="list-style-type: none"> Latchbolt by lever either side. Both levers always free.
		Privacy Bedroom or Bathroom	HF 76	<ul style="list-style-type: none"> Latchbolt by lever either side, except when push button locks outside lever. (Lever handle is free-wheeling in locked position.) Outside lever locked by push button. Outside lever unlocked by emergency release tools by rotating inside lever or by closing door.
		Patio or Privacy	HF 77	<ul style="list-style-type: none"> Deadlocking latchbolt by lever either side except when push button locks outside lever. (Lever handle is free-wheeling in locked position.) Outside lever locked by push button. Outside lever unlocked by rotating inside lever or by closing door. Inside lever always free. Should not be used in rooms that have no other entrance.
		Hotel or Motel	HF 93	<ul style="list-style-type: none"> Throw-off latchbolt by lever inside or by key outside. Pushing turn button shuts out all keys except emergency key and projects occupancy indicator in face of cylinder. Pushing turn button released by turning inside lever or closing door. Outside lever always rigid. Inside lever always free.
		Entrance or Office	HF 81	<ul style="list-style-type: none"> Deadlocking latchbolt by either side except when turn button locks outside lever. (Lever handle is free-wheeling in locked position.) Pushing turn button locks outside lever, requiring use of key outside to unlock. Turning inside lever unlocks outside lever. Pushing in and turning button locks outside lever, requiring key at all times. Turning inside lever does not unlock outside lever until button is manually turned to unlocked position.
		Classroom	HF 84	<ul style="list-style-type: none"> Deadlocking latchbolt by lever either side except when key outside locks outside lever. (Lever handle is free-wheeling in locked position.) Outside lever unlocked by key outside. Inside lever always free.
		Storeroom	HF 86	<ul style="list-style-type: none"> Deadlocking latchbolt by key in outside lever or by rotating inside lever. (Lever handle is free-wheeling in locked position.) Outside lever always rigid. Inside lever always free.

Cylindrical Lever Locksets

Function

Inside	Outside	Type	ANSI	Function Description
		Communicating (Storeroom)	HF 87	<ul style="list-style-type: none"> - Bothside lever rigid. - Bothside lever operated by key only.
		Communicating (Classroom)	HF 88	<ul style="list-style-type: none"> - Key in either lever locks or unlocks its own lever independently.
		Exit or Twin communicating	HF 89A	<ul style="list-style-type: none"> - Guard bolt deadlocks latch bolt. - Blank plate outside. - Latch bolt by lever inside. - Minimum clearance of 1" required between doors.
		Exit	HF 89B	<ul style="list-style-type: none"> - Deadlocking latchbolt by lever except when key locks lever. (Lever handle is free-wheeling in locked position.) - Lever on one side; blank plate on other side.
		Exit	HF 89C	<ul style="list-style-type: none"> - Guard bolt deadlocks latch bolt. - Latch bolt by lever inside. - Outside lever rigid.
		Half Dummy Trim	-	<ul style="list-style-type: none"> - Lever acts as pull only; no operation.
		Full Dummy Trim	-	<ul style="list-style-type: none"> - Lever acts as pull only; no operation.

 Indicates optional Interchangeable Core available.

 Indicates rigid lever.

Cylindrical Lever Locksets

Key & Cylinder Specifications

Key system

Great Grand Master Key

Grand Master Key

Master Key

Change Key

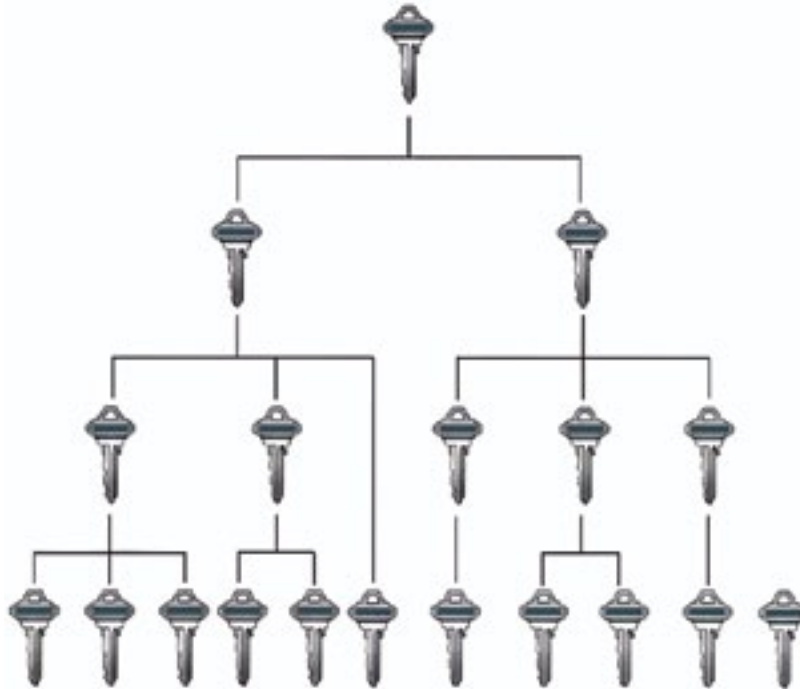

Standard keying terms

Key & Terms	Code	Definition
Change Key	-	Individual Lock Key
Keyed Different	KD	Each Lock is set to a different key combination
Keyed Alike	KA	Two or more locks set to the same key combination, KA2, KA3, KA4 & etc
Masterkey	MK	Operates any given quantity of cylinders with different key changes
Grand Masterkey	GMK	Operates all individual locks already operated by two or more masterkeys
Great Grand Masterkey	GGMK	Operates all locks under the various Masterkeys and Grand Masterkeys already established
Emergency Key	EMK	Operates Hotel Locks having shutout feature which blocks entry by all other keys
Construction Key	CK	Operates all Cylinders designated for a temporary period during construction
Keyway		Broaching in Cylinder Barrel

Cylindrical Lever Locksets

Specifications

1. Use two letters for both Masterkeyed and Grand Masterkeyed systems.
 - a. Masterkey systems have change key numbers prefixed. Example : 1 AA, 2AA
 - b. Grand Masterkey systems have change key # suffixed. Example : AA1, AA2
2. Each change combination has a different number affixed to letter symbol.
Every keyed different cylinder must be listed with a different number.
Cylinders in keyed alike groups will have the same number affixed.
3. Letter symbol only (A) indicates to be operated by Grand Masterkey only, no change key
(Single letter would not be used at all in simple Masterkey system)
4. Two letter symbol only (AA) indicates to be operated by: AA Masterkey and A grand Masterkey only, no change key.
5. Symbol A1, A2; these are changes under the "A" grand Masterkey only.
6. Symbol GGM1, GGM2; these are changes under Great Grand Masterkey only.
7. Symbol 1AA, 2AA, etc. used in Great Grand Masterkey system. The change numbers are prefixed on all locks operated by Master Keys under Great Grand Masterkey only, no grand Masterkey operates these locks.
8. Symbol SKD1, SKD2, etc-single keyed-used for locks in a Master, Grand Master or Great Grand Masterkey system. These locks operated by their change keys only (not Masterkeyed, Grand Masterkeyed, etc.)

<Example: Key System>

Simple Master Key		Grand Master Key			
Grand	N/A	Grand Master key	A		
Master	AA	Master key	AA	AB	AC
Change Key	AA1	Change Key	AA1	AB1	AC1
	AA2		AA2	AB2	AC2
	AA3		AA3	AB3	AC3

Keybow & Keyway



Schlage
5 or 6 pin

Kwikset
5 or 6 pin

Arrow
5 pin

Weiser
5 pin

Lockwood C4
6 pin



SmartLoc Technology

10125 S. 52nd Street

Franklin, WI 53132

Tel: (888) 651-LOCK

Fax: 414-858-9340

Sales@SmartLocWorld.com

www.SmartLocWorld.com